

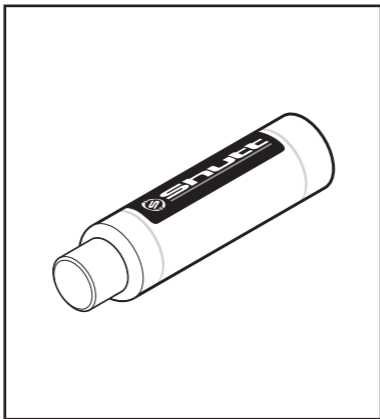

shutt

Shutt Emergency Brake Handle



Instructions Manual





SHUTT

Emergency Brake Handle

Instructions

Thanks for buying our product. Projected to join comfort and beauty, our products follow the most demanding patterns of quality.

Important recommendations:

- 1) Before installation, read the instructions very carefully;
- 2) Use the adequate tools for installation of this emergency brake handle.

Content of this packing:

- 1) 1 (one) emergency brake handle;
- 2) 1 (one) lid for emergency brake handle;
- 3) 2 (two) little metal plates;
- 4) 2 (two) long screws and 2 (two) short screws;
- 5) 1 (one) coil;
- 6) 1 (one) allen screw driver.

Assembly project:

- 1) Loosen the screws using the allen screw driver;
- 2) Put the lid inside the emergency brake handle;
- 3) Put the coil (with the bigger diameter to inside);
- 4) Insert the little metal plates so that the screws stay in the direction of the holes in it;
- 5) Fit the set onto the axle;
- 6) If it presents looseness, use the non-perforated metal plate to adjust;
- 7) Tighten the screws using the allen screw driver.

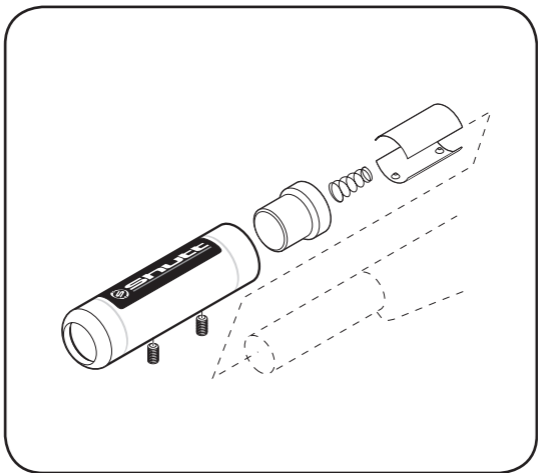



Shutt Limited Warranty

Shutt products are warranted for ninety days from date of purchase against manufacturing defects in materials or workmanship. During this warranty period, Shutt shall repair or replace, at its sole option, all parts that are found by Shutt to be defective and subject to this Limited Warranty. This Limited Warranty is made only to the original owner of this new Shutt product, and it shall remain in force only as long as the original owner retains ownership of the product. This Limited Warranty is not transferable. This Limited Warranty does not apply to normal wear and tear, nor to defects, malfunctions or failures that result from the abuse, neglect, shocks or crashes, improper maintenance, alteration, modification, accident, or misuse (including competitive or commercial racing), nor damage occurring during shipment. Shutt shall not be responsible for any direct, incidental, consequential or exemplary damages suffered by any party. Proof of purchase and date of purchase are required to validate warranty. This Limited Warranty gives you legal rights accordingly; you may also have other legal rights which vary from state to state and country to country.

171500106

Purchase date:

Store:

Stamp

Uneni Ind. Com. Imp. Exp. Ltda. - C.N.P.J. 74.522.251/0001-72